

FOR LEASE



23 GRAHAM STREET MILTON

Location

23 Graham Street is a four storey modern office building located in the heart of Milton. The property is located only a short walk from the retail amenity offered within the Park Road precinct and is in close proximity to multiple transport nodes including the Milton Train Station and the new Milton City Cat terminal.

Current Vacancy

100m² - 700m²

Availability

Available now

Rent \$/m²

\$200/m² gross

Contact

Mitch Connell
0430 221 177
mitch@tridentcorporation.com.au

Matthew Gleeson
0407 876 681
matt@tridentcorporation.com.au



Level 1

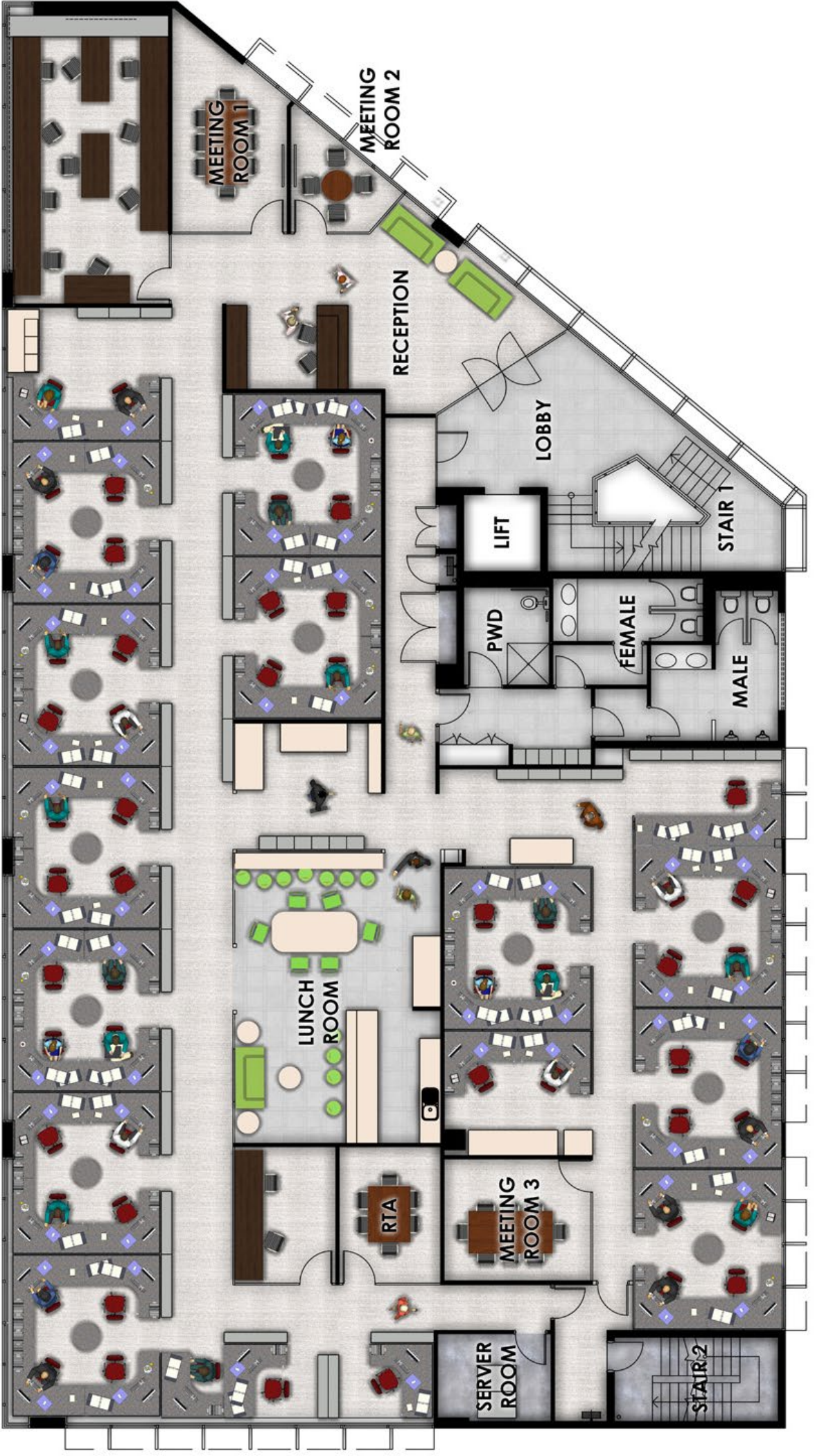

Level 2

